



operating

OPERATING MANUAL

ASSEMBLY/USAGE DELUXE SERIES RAISED TOILET SEATS
FOR MODELS:

1632 2" Seat

1634 4" Seat

1636 6" Seat

WARNINGS

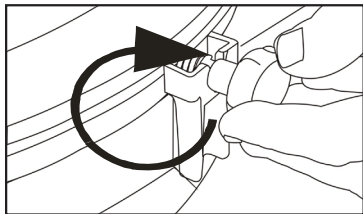

Never overtighten the clamps as this could cause damage to the toilet bowl or the seat itself.

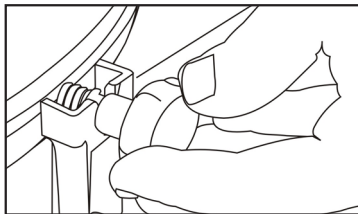

Check your raised toilet seat every week to ensure all clamps are securely tightened.

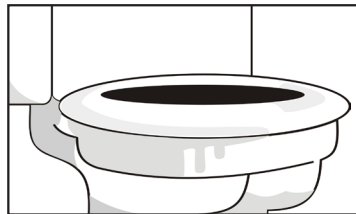

Only use the raised toilet seat on toilets that meet the specifications. Ensure the seat rests well on the toilet frame.



DO NOT exceed weight capacity!



DO NOT USE THE RAISED TOILET SEAT IF THERE ARE ANY CRACKS OR DAMAGED COMPONENTS!

CARE AND USE

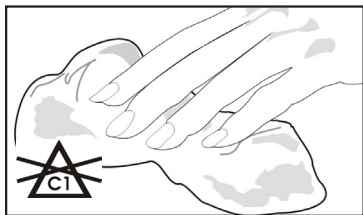

DO NOT use chlorine bleach or abrasive cleansers. To clean, wipe down with a damp cloth using a mild detergent only.

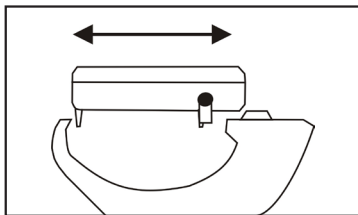

This raised toilet seat will only fit standard toilet seats (approximate size: 12³/₄" x 10¹/₄"/32cm x 26cm).



Supervision or assistance when using seats is recommended for users with limited mobility.

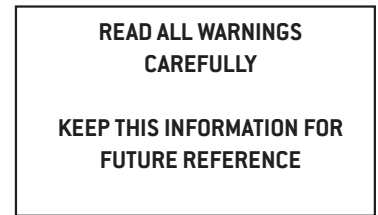

ASSEMBLY



Before installing your raised toilet seat, make sure your toilet is dry and dirt free.

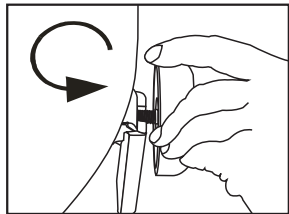

Turn knobs counterclockwise until brackets are fully extended.

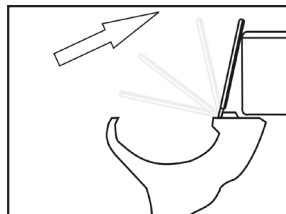

Lift the existing seat and place the raised toilet seat onto the toilet bowl. For Model #1637 the lid must first be removed.

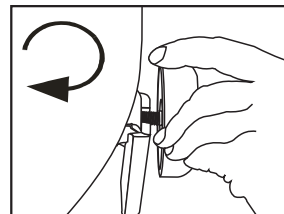

Turn the knobs clockwise until clamp pads are firm against toilet. **DO NOT OVERTIGHTEN!**

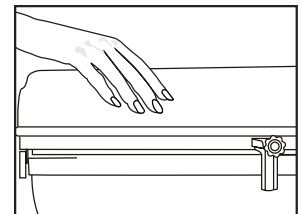

Check the tightness of fit from time to time.

IF YOU HAVE ANY PROBLEMS OR REQUIRE ASSISTANCE WITH THIS PRODUCT PLEASE CALL:

613-723-6734



HUMAN CARE CANADA, INC.
10-155 Colonnade Road
Ottawa, ON K2E 7K1

MADE IN CHINA



HUMAN CARE
Your Life. Your Way.